

# Orbital Sanders

Fuji Orbital Sanders are compact, lightweight & manoeuvrable, yet powerful enough for finishing lacquered and metal surfaces prior to re-painting. The effective dust extraction with rear exhaust helps to keep the working environment clean.

## Features

- Powerful sanding, high stability and low vibration.
- Excellent dust extraction ability to help keep the work area clean
- Available to suit variations of sandpapers; self-adhesive type, Velcro (Nylon Strip Fastener) Type and standard Clip-on Type.

### DISC TYPE



**FOR-125BF, 150BF**

Model	Capacity (Sanding Disc)		Free Speed min <sup>-1</sup>	Angle Head Height		Power		Overall Length		Weight		Max. Air Consumption		Air Hose Size	
	mm	in		mm	in	kW	hp	mm	in	kg	lb	m <sup>3</sup> /min	ft <sup>3</sup> /min	mm	in
<b>Locking Lever Handle Models</b>															
<b>FOR-125BF-E(M)</b>	ø125	5	8,000	124	4 7/8	0.118	0.158	243	9 9/16	2.0	4.4	0.36	12.7	6.3	1/4
<b>FOR-150BF-E(M)</b>	ø150	6	8,000	124	4 7/8	0.118	0.158	256	10 5/64	2.1	4.6	0.36	12.7	6.3	1/4

\*Air Inlet Thread Size: BSP or NPT 1/4".

\*Adhesive paper type: (E). \*Velcro paper type : (M).

\*FOR Series, Orbit 9mm (11/32")

### RECTANGLE SHEET TYPE



**FOS-175BF**

Model	Capacity (Sanding Pad Size)		Free Speed min <sup>-1</sup>	Angle Head Height		Power		Overall Length		Weight		Max. Air Consumption		Air Hose Size	
	mm	in		mm	in	kW	hp	mm	in	kg	lb	m <sup>3</sup> /min	ft <sup>3</sup> /min	mm	in
<b>Locking Lever Handle Models</b>															
<b>FOS-175BF-E(M)</b>	100 x 175	4 x 7	6,500	130	5 1/8	0.118	0.158	268	10 9/16	2.4	5.2	0.34	11.9	6.3	1/4
<b>FOS-230BF-E</b>	100 x 230	4 x 9	6,000	130	5 1/8	0.118	0.158	291	11 29/64	2.6	5.7	0.34	11.9	6.3	1/4
<b>FOS-400BF-E</b>	100 x 400	4 x 16	5,500	130	5 1/8	0.118	0.158	400	16	3.3	7.2	0.32	11.3	6.3	1/4

\*Air Inlet Thread Size: BSP or NPT 1/4".

\*Adhesive paper type: (E). \*Velcro paper type : (M).

\*FOS Series, Orbit 5mm (3/16")

## ACCESSORIES PROVIDED



Model	Exhaust Hose	Dust Bag	Spanner	Punching Tool / Rod	Sanding Disc
FOR-125B	●	●	●	Rod	● 2pcs.
FOR-150B	●	●	●	Rod	● 2pcs.
FOS-175BF	●	●	-	-	● 2pcs.
FOS-230BF-E	●	●	-	●	● 2pcs.
FOS-400BF-E	●	●	-	●	● 2pcs.

\* ● = provided, - = not provided

## HOLE PATTERN AND DIMENSIONS OF SANDING PAPERS AND PADS

### Disc Type

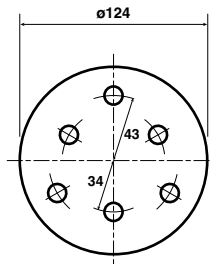

FOR-125 Series

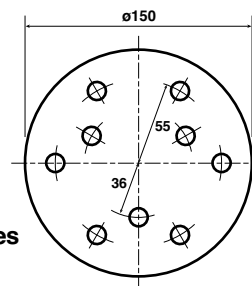

FOR-150 Series

Model	Adhesive Paper Type		Velcro Paper Type	
	Paper	Pad	Paper	Pad
FOR-125	FOR-125-#40~#150	PAD-125E	FOR-125-M40~M600	PAD-125M
FOR-150	FOR-150-#40~#150	PAD-150E	FOR-150-M40~M600	PAD-150M

\* Specify the grit when ordering sanding papers.

### Rectangle Sheet Type

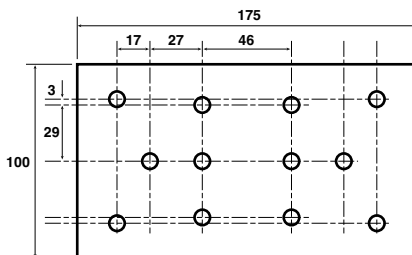

FOS-175 Series

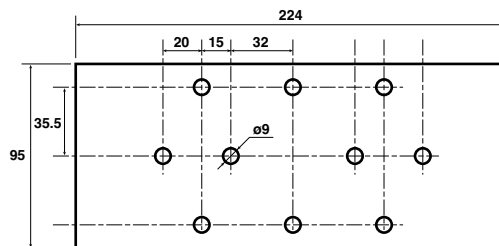

FOS-230 Series

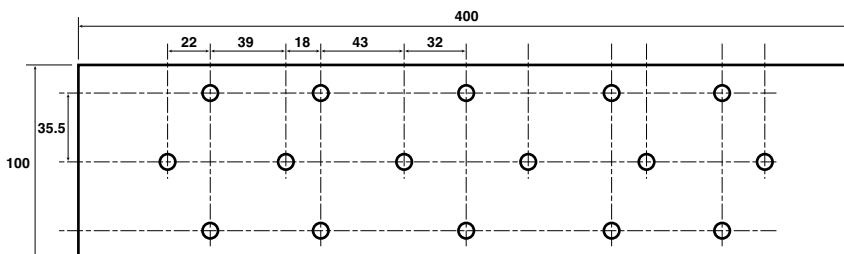

FOS-400 Series

Model	- Adhesive Paper Type		Velcro Paper Type		Roll Paper (Clip-on type)
	Paper	Pad	Paper	Pad	
FOS-175	FOS-175-#40~#240	PAD-175E	FOS-175-M40~M600	PAD-175M	-
FOS-230	FOS-230-#40~#240	PAD-230E	-	-	FOS-230-C40~C240
FOS-400	FOS-400-#40~#240	PAD-400E	-	-	FOS-400-C40~C240

\* Roll Paper Size: 100mm x 15m (Dimension: FOS-230 (100 x 300)mm, FOS-400 (100 x 470) mm).

\* Specify the grit when ordering sanding papers.